

ADAPTER SLEEVES METRIC <200MM

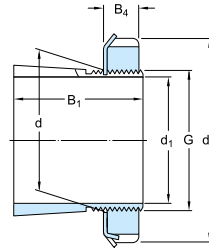

H

d ₁ (mm)	d (mm)	d ₃ (mm)	B ₁ (mm)	B ₄ (mm)	G	kg	Adapter Sleeve	Lock Nut	Locking Device	Appropriate Hydraulic Nut	Bearing(s)
17	20	32	24	7	M 20x1	0,036	H 204	KM 4	MB 4	-	1204K
	20	32	28	7	M 20x1	0,04	H 304	KM 4	MB 4	-	1304K, 2204K, 21304K
20	25	38	26	8	M 25x1.5	0,064	H 205	KM 5	MB 5	-	1205K
	25	38	29	9	M 25x1.5	0,071	H 305	KM 5	MB 5	-	1305K, 2205K, 21305K
25	30	45	27	8	M 30x1.5	0,086	H 206	KM 6	MB 6	-	1206K
	30	45	31	9	M 30x1.5	0,095	H 306	KM 6	MB 6	-	1306K, 2206K, 21306K
	30	45	38	8	M 30x1.5	0,11	H 2306	KM 6	MB 6	-	2306K
30	35	52	29	9	M 35x1.5	0,12	H 207	KM 7	MB 7	-	1207K
	35	52	35	10	M 35x1.5	0,14	H 307	KM 7	MB 7	-	1307K, 2207K, 21307K
	35	52	43	9	M 35x1.5	0,16	H 2307	KM 7	MB 7	-	2307K
35	40	58	31	10	M 40x1.5	0,16	H 208	KM 8	MB 8	-	1208K
	40	58	36	11	M 40x1.5	0,17	H 308	KM 8	MB 8	-	1308K, 2208K, 21308K, 22208K
	40	58	46	10	M 40x1.5	0,22	H 2308	KM 8	MB 8	-	2308K, 22308K
40	45	65	33	11	M 45x1.5	0,21	H 209	KM 9	MB 9	-	1209K
	45	65	39	12	M 45x1.5	0,23	H 309	KM 9	MB 9	-	1309K, 2209K, 21309K, 22209K
	45	65	50	11	M 45x1.5	0,27	H 2309	KM 9	MB 9	-	2309K, 22309K
45	50	70	35	12	M 50x1.5	0,24	H 210	KM 10	MB 10	HMV 10 E	1210K
	50	70	42	13	M 50x1.5	0,27	H 310	KM 10	MB 10	HMV 10 E	1310K, 2210K, 21310K, 22210K
	50	70	55	12	M 50x1.5	0,34	H 2310	KM 10	MB 10	HMV 10 E	2310K, 22310K
50	55	75	37	12,5	M 55x2	0,28	H 211	KM 11	MB 11	HMV 11 E	1211K
	55	75	45	13	M 55x2	0,34	H 311	KM 11	MB 11	HMV 11 E	1311K, 2211K, 21311K, 22211K
	55	75	59	12,5	M 55x2	0,39	H 2311	KM 11	MB 11	HMV 11 E	2311K, 22311K
55	60	80	38	12,5	M 60x2	0,31	H 212	KM 12	MB 12	HMV 12 E	1212K
	60	80	47	14	M 60x2	0,36	H 312	KM 12	MB 12	HMV 12 E	1312K, 2212K, 21312K, 22212K
	60	80	62	12,5	M 60x2	0,45	H 2312	KM 12	MB 12	HMV 12 E	2312K, 22312K
60	65	85	40	13,5	M 65x2	0,36	H 213	KM 13	MB 13	HMV 13 E	1213K
	65	85	50	13,5	M 65x2	0,42	H 313	KM 13	MB 13	HMV 13 E	1313K, 2213K, 21313K, 22213K
	65	85	65	13,5	M 65x2	0,52	H 2313	KM 13	MB 13	HMV 13 E	2313K, 22313K
	70	92	41	14	M 70x2	0,55	H 214	KM 14	MB 14	HMV 14 E	1214K
	70	92	52	13,5	M 70x2	0,67	H 314	KM 14	MB 14	HMV 14 E	1314K, 2214K, 21314K, 22214K
65	70	92	68	13,5	M 70x2	0,88	H 2314	KM 14	MB 14	HMV 14 E	2314K, 22314K
	75	98	43	14,5	M 75x2	0,66	H 215	KM 15	MB 15	HMV 15 E	1215K
	75	98	55	14,5	M 75x2	0,78	H 315	KM 15	MB 15	HMV 15 E	1315K, 2215K, 21315K, 22215K
70	75	98	73	14,5	M 75x2	1,1	H 2315	KM 15	MB 15	HMV 15 E	2315K, 22315K
	80	105	46	17	M 80x2	0,81	H 216	KM 16	MB 16	HMV 16 E	1216K
	80	105	59	17	M 80x2	0,95	H 316	KM 16	MB 16	HMV 16 E	1316K, 2216K, 21316K, 22216K
80	105	78	17	M 80x2	1,2	H 2316	KM 16	MB 16	HMV 16 E	2316K, 22316K	

ADAPTER SLEEVES METRIC <200MM

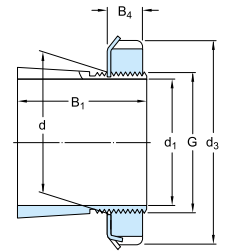

H

d ₁ (mm)	d (mm)	d ₃ (mm)	B ₁ (mm)	B ₄ (mm)	G	kg	Adapter Sleeve	Lock Nut	Locking Device	Appropriate Hydraulic Nut	Bearing(s)
75	85	110	50	18	M 85x2	0,94	H 217	KM 17	MB 17	HMV 17 E	1217K
	85	110	63	18	M 85x2	1,1	H 317	KM 17	MB 17	HMV 17 E	1317K, 2217K, 21317K, 22217K
	85	110	82	18	M 85x2	1,35	H 2317	KM 17	MB 17	HMV 17 E	2317K, 22317K
80	90	120	52	18	M 90x2	1,1	H 218	KM 18	MB 18	HMV 18 E	1218K
	90	120	65	18	M 90x2	1,3	H 318	KM 18	MB 18	HMV 18 E	1318K, 2218K, 21318K, 22218K
	90	120	86	18	M 90x2	1,6	H 2318	KM 18	MB 18	HMV 18 E	2318K, 22318K
85	95	125	55	19	M 95x2	1,25	H 219	KM 19	MB 19	HMV 19 E	1219K
	95	125	68	19	M 95x2	1,4	H 319	KM 19	MB 19	HMV 19 E	1319K, 2219K, 21319K, 22219K
	95	125	90	19	M 95x2	1,8	H 2319	KM 19	MB 19	HMV 19 E	2319K, 22319K
90	100	130	58	20	M 100x2	1,4	H 220	KM 20	MB 20	HMV 20 E	1220K
	100	130	71	20	M 100x2	1,6	H 320	KM 20	MB 20	HMV 20 E	1320K, 2220K, 21320K, 22220K
	100	130	76	20	M 100x2	1,8	H 3120	KM 20	MB 20	HMV 20 E	23120K
	100	130	97	20	M 100x2	2	H 2320	KM 20	MB 20	HMV 20 E	2320K, 22320K
100	110	145	63	21	M 110x2	1,8	H 222	KM 22	MB 22	HMV 22 E	1222K
	110	145	77	21	M 110x2	2,04	H 322	KM 22	MB 22	HMV 22 E	1322K, 2222K, 21322K, 22222K
	110	145	81	21	M 110x2	2,1	H 3122	KM 22	MB 22	HMV 22 E	23122K, 22222K
	110	145	105	21	M 110x2	2,75	H 2322	KM 22	MB 22	HMV 22 E	2322K, 22322K
110	120	145	72	22	M 120x2	1,8	H 3024	KML 24	MBL 24	HMV 24 E	23024K
	120	155	88	22	M 120x2	2,5	H 3124	KM 24	MB 24	HMV 24 E	23124K, 22224K
	120	155	112	22	M 120x2	3	H 2324	KM 24	MB 24	HMV 24 E	2324K, 22324K
115	130	155	80	23	M 130x2	2,8	H 3026	KML 26	MBL 26	HMV 26 E	23026K
	130	165	92	23	M 130x2	3,45	H 3126	KM 26	MB 26	HMV 26 E	23126K, 22226K
	130	165	121	23	M 130x2	4,45	H 2326	KM 26	MB 26	HMV 26 E	2326K, 22326K
125	140	165	82	24	M 140x2	3,05	H 3028	KML 28	MBL 28	HMV 28 E	23028K
	140	180	97	24	M 140x2	4,1	H 3128	KM 28	MB 28	HMV 28 E	23128K, 22228K
	140	180	131	24	M 140x2	5,4	H 2328	KM 28	MB 28	HMV 28 E	2328K, 22328K
135	150	180	87	26	M 150x2	3,75	H 3030	KML 30	MBL 30	HMV 30 E	23030K
	150	195	111	26	M 150x2	5,25	H 3130	KM 30	MB 30	HMV 30 E	23130K, 22230K
	150	195	139	26	M 150x2	6,4	H 2330	KM 30	MB 30	HMV 30 E	2330K, 22330K
140	160	190	93	27,5	M 160x3	5,1	H 3032	KML 32	MBL 32	HMV 32 E	23032K
	160	210	119	27,5	M 160x3	7,25	H 3132	KM 32	MB 32	HMV 32 E	23132K, 22232K
	160	210	147	27,5	M 160x3	8,8	H 2332	KM 32	MB 32	HMV 32 E	2332K, 22332K
150	170	200	101	28,5	M 170x3	5,8	H 3034	KML 34	MBL 34	HMV 34 E	23034K
	170	220	122	28,5	M 170x3	8,1	H 3134	KM 34	MB 34	HMV 34 E	23134K, 22234K
	170	220	154	28,5	M 170x3	9,9	H 2334	KM 34	MB 34	HMV 34 E	2334K, 22334K
160	180	210	109	29,5	M 180x3	6,7	H 3036	KML 36	MBL 36	HMV 36 E	23036K
	180	230	131	29,5	M 180x3	9,15	H 3136	KM 36	MB 36	HMV 36 E	23136K, 22236K
	180	230	161	30	M 180x3	11	H 2336	KM 36	MB 36	HMV 36 E	2336K, 22336K
170	190	220	112	30,5	M 190x3	7,25	H 3038	KML 38	MBL 38	HMV 38 E	23038K
	190	240	141	30,5	M 190x3	10,5	H 3138	KM 38	MB 38	HMV 38 E	23138K, 22238K
	190	240	169	30,5	M 190x3	12	H 2338	KM 38	MB 38	HMV 38 E	2338K, 22338K
180	200	240	120	31,5	M 200x3	8,9	H 3040	KML 40	MBL 40	HMV 40 E	23040K
	200	250	150	31,5	M 200x3	12	H 3140	KM 40	MB 40	HMV 40 E	23140K, 22240K
	200	250	176	31,5	M 200x3	13,5	H 2340	KM 40	MB 40	HMV 40 E	2340K, 22340K

ADAPTER SLEEVES METRIC $\geq 200\text{MM}$

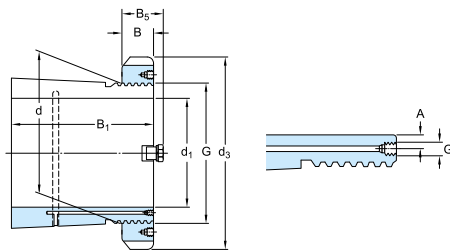

OH .. H

d_1 (mm)	d (mm)	d_3 (mm)	B_1 (mm)	B (mm)	B_5 (mm)	G	G_2	A (mm)	kg	Adapter Sleeve	Lock Nut	Locking Device	Appropriate Hydraulic Nut	Bearing(s)
200	220	260	126	30	41	Tr 220x4	M6	4,2	9,9	OH 3044 H	HM 3044	MS 3044	HMV 44 E	23044K
	220	280	161	35	-	Tr 220x4	M6	4,2	15	OH 3144 H	HM 3044	MB 44	HMV 44 E	23144K, 22244K
	220	280	186	35	-	Tr 220x4	M6	4,2	17	OH 2344 H	HM 3044	MB 44	HMV 44 E	2344K, 22344K
220	240	290	133	34	46	Tr 240x4	M6	4,2	12	OH 3048 H	HM 3048	MS 3052-48	HMV 48 E	23048K
	240	300	172	37	-	Tr 240x4	M6	4,2	165	OH 3148 H	HM 3048	MB 48	HMV 48 E	23148K, 22248K
	240	300	199	37	-	Tr 240x4	M6	4,2	19	OH 2348 H	HM 3048	MB 48	HMV 48 E	2348K, 22348K
240	260	310	145	34	46	Tr 260x4	M6	4,2	13,5	OH 3052 H	HM 3052	MS 3052-48	HMV 52 E	23052K
	260	330	190	39	-	Tr 260x4	M6	4,2	21	OH 3152 H	HM 3052	MB 52	HMV 52 E	23152K, 22252K
	260	330	211	39	-	Tr 260x4	M6	4,2	24,2	OH 2352 H	HM 52 T	MB 52	HMV 52 E	2352K, 22352K
260	280	330	152	38	50	Tr 280x4	M6	4,2	16	OH 3056 H	HM 3056	MS 3056	HMV 56 E	23056K
	280	350	195	41	-	Tr 280x4	M6	4,2	23	OH 3156 H	HM 3056	MB 56	HMV 56 E	23156K, 22256K
	280	350	224	41	-	Tr 280x4	M6	4,2	27,8	OH 2356 H	HM 56 T	MB 56	HMV 56 E	2356K, 22356K
280	300	360	168	42	54	Tr 300x4	M6	4,2	20,5	OH 3060 H	HM 3060	MS 3060	HMV 60 E	23060K
	300	380	208	40	53	Tr 300x4	M6	4,2	29	OH 3160 H	HM 3160	MS 3160	HMV 60 E	23160K, 22260K
	300	380	240	40	53	Tr 300x4	M6	4,2	32	OH 3260 H	HM 3160	MS 3160	HMV 60 E	23260K
300	320	380	171	42	55	Tr 320x5	M6	4	22	OH 3064 H	HM 3064	MS 3068-64	HMV 64 E	23064K
	320	400	226	42	56	Tr 320x5	M6	4	32	OH 3164 H	HM 3164	MS 3164	HMV 64 E	23164K, 22264K
	320	400	258	42	56	Tr 320x5	M6	4	35	OH 3264 H	HM 3164	MS 3164	HMV 64 E	23264K
320	340	400	187	45	58	Tr 340x5	M6	4	27	OH 3068 H	HM 3068	MS 3068-64	HMV 68 E	23068K
	340	440	254	55	72	Tr 340x5	M6	4	50	OH 3168 H	HM 3168	MS 3172-68	HMV 68 E	23168K, 22268K
	340	440	288	55	72	Tr 340x5	M6	4	51,5	OH 3268 H	HM 3168	MS 3172-68	HMV 68 E	23268K
340	360	420	188	45	58	Tr 360x5	M6	4	29	OH 3072 H	HM 3072	MS 3072	HMV 72 E	23072K
	360	460	259	58	75	Tr 360x5	M6	4	56	OH 3172 H	HM 3172	MS 3172-68	HMV 72 E	23172K, 22272K
	360	460	299	58	75	Tr 360x5	M6	4	60,5	OH 3272 H	HM 3172	MS 3172-68	HMV 72 E	23272K
360	380	450	193	48	62	Tr 380x5	M6	4	35,5	OH 3076 H	HM 3076	MS 3080-76	HMV 76 E	23076K
	380	490	264	60	77	Tr 380x5	M6	4	61,5	OH 3176 H	HM 3176	MS 3176	HMV 76 E	23176K, 22276K
	380	490	310	60	77	Tr 380x5	M6	4	69,5	OH 3276 H	HM 3176	MS 3176	HMV 76 E	23276K

ADAPTER SLEEVES METRIC ≥200MM

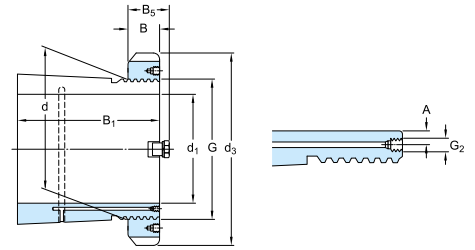

OH .. H

d ₁ (mm)	d (mm)	d ₃ (mm)	B ₁ (mm)	B (mm)	B ₅ (mm)	G	G ₂	A (mm)	kg	Adapter Sleeve	Lock Nut	Locking Device	Appropriate Hydraulic Nut	Bearing(s)
380	400	470	210	52	66	Tr 400x5	M6	4	40	OH 3080 H	HM 3080	MS 3080-76	HMV 80 E	23080K
	400	520	272	62	82	Tr 400x5	M6	4	73	OH 3180 H	HM 3180	MS 3184-80	HMV 80 E	23180K, 22280K
	400	520	328	62	82	Tr 400x5	M6	4	87	OH 3280 H	HM 3180	MS 3184-80	HMV 80 E	23280K
400	420	490	212	52	66	Tr 420x5	M6	4	47	OH 3084 H	HM 3084	MS 3084	HMV 84 E	23084K
	420	540	304	70	90	Tr 420x5	M6	4	80	OH 3184 H	HM 3184	MS 3184-80	HMV 84 E	23184K, 22284K
	420	540	352	70	90	Tr 420x5	M6	4	96	OH 3284 H	HM 3184	MS 3184-80	HMV 84 E	23284K
410	440	520	228	60	77	Tr 440x5	M8	6,5	65	OH 3088 H	HM 3088	MS 3092-88	HMV 88 E	23088K
	440	560	307	70	90	Tr 440x5	M8	6,5	95	OH 3188 H	HM 3188	MS 3192-88	HMV 88 E	23188K, 22288K
	440	560	361	70	90	Tr 440x5	M8	6,5	117	OH 3288 H	HM 3188	MS 3192-88	HMV 88 E	23288K
430	460	540	234	60	77	Tr 460x5	M8	6,5	71	OH 3092 H	HM 3092	MS 3092-88	HMV 92 E	23092K
	460	580	326	75	95	Tr 460x5	M8	6,5	119	OH 3192 H	HM 3192	MS 3192-88	HMV 92 E	23192K, 22292K
	460	580	382	75	95	Tr 460x5	M8	6,5	134	OH 3292 H	HM 3192	MS 3192-88	HMV 92 E	23292K
450	480	560	237	60	77	Tr 480x5	M8	6,5	75	OH 3096 H	HM 3096	MS 30/500-96	HMV 96 E	23096K
	480	620	335	75	95	Tr 480x5	M8	6,5	135	OH 3196 H	HM 3196	MS 3196	HMV 96 E	23196K, 22296K
	480	620	397	75	95	Tr 480x5	M8	6,5	153	OH 3296 H	HM 3196	MS 3196	HMV 96 E	23296K
470	500	580	247	68	85	Tr 500x5	M8	6,5	82	OH 30/500 H	HM 30/500	MS 30/500-96	HMV 100 E	230/500K
	500	630	356	80	100	Tr 500x5	M8	6,5	145	OH 31/500 H	HM 31/500	MS 31/500	HMV 100 E	231/500K, 222/500K
	500	630	428	80	100	Tr 500x5	M8	6	170	OH 32/500 H	HM 31/500	MS 31/500	HMV 100 E	232/500K

